

Major League Electronics .100 cl Jumpers

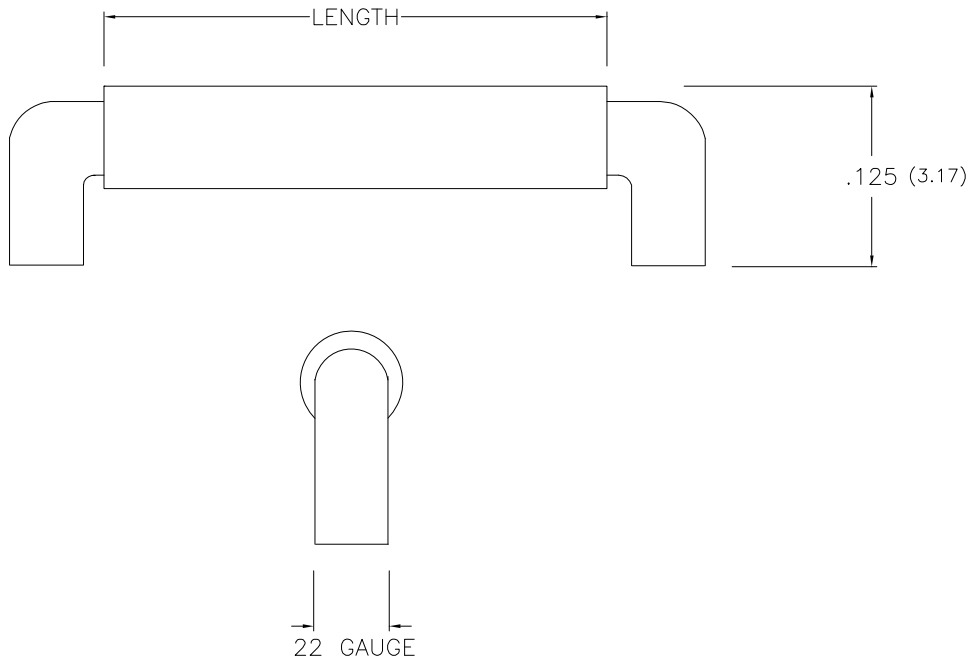

Ordering Information

JP-1 T - XXX

Plating Options	
- 60μ (min.) in Tin over 60μ (min.) Copper	T

Length		
.100	2.54mm	100
.250	6.35mm	250
.350	7.62mm	300
.400	10.16mm	400
.500	12.70mm	500
.600	15.24mm	600

Specifications

Current Rating: 3.0 Ampere
 Insulation Resistance: 1000MΩ Min.
 Dielectric Withstanding: 600V AC
 Contact Resistance: 20 mΩ Max.
 Operating Temperature: -40°C to + 105°C

Materials

Contact Material: Phosphor Bronze
 Insulator Material: Nylon 6T

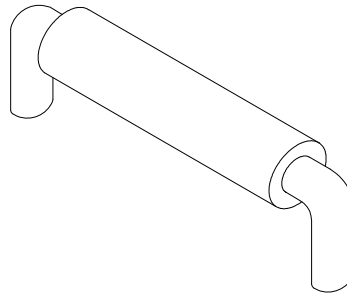

Products cut to specific sizes are uncancellable/nonreturnable

Parts are subject to change without notice

JP-1-T SERIES

.100 cl Jumper - Through Hole

16 Jan 07

Scale
NTS

UNLESS OTHERWISE SPECIFIED
 DIMENSIONS IN INCHES (MM)
 TOLERANCES ARE:

ONE PLACE DECIMALS ±.100
 TWO PLACE DECIMALS ±.010
 THREE PLACE DECIMALS ±.005
 FOUR PLACE DECIMALS ±.0020
 ANGLES
 ±5°



4235 Earnings Way, New Albany, Indiana, 47150, USA
 1-800-782-3486 (USA/Canada/Mexico)
 Tel: 812-944-7244
 Fax: 812-944-7268
 E-mail: mle@mlelectronics.com
 Web: www.mlelectronics.com

Edition
1

Sheet
1/1